



improve your life

CE

EN

TECH TOWER HUMY

DIGITAL CERAMIC FAN HEATER WITH HUMIDIFICATION AND AMBIENT LIGHT



This product is only suitable for correctly-insulated environments or for occasional use.

OPERATING INSTRUCTIONS

Read the instructions carefully before operating the appliance or carrying out maintenance operations. Observe all the safety instructions; failure to observe the instructions may lead to accidents and/or damage. Keep these instructions in a safe place for future reference.

GENERAL SAFETY INFORMATION

- Use this fan heater only as outlined in this manual. Any other use not recommended by the manufacturer may cause fire, electric shock or injury to persons.
- Make sure that the type of mains power complies with the electrical requirements of the fan heater (220-240V~/50-60 Hz).
- This appliance can be used by children of at least 8 years of age and by people with reduced physical, sensory or mental abilities, or who lack sufficient experience or the necessary knowledge, provided that they are supervised or have been instructed on how to use the appliance safely and understand the hazards related to its use.
- Children must not be allowed to play with the appliance.
- Cleaning and maintenance operations normally carried out by the user must not be performed by unsupervised children.
- This product is not a toy. Children under the age of 3 must be kept away if not continuously supervised.
- Children aged between 3 and 8 must only turn the appliance on/off as long as it has been placed or installed in its normal operating position and that they receive surveillance or instructions regarding the safe use of the appliance and understand the dangers.
- Children between 3 and 8 years of age must not insert the plug, adjust or clean the appliance or carry out maintenance by the user.
- **WARNING: Certain parts of this product may become very hot and cause burns. Special care should be taken when children and vulnerable people are nearby.**
- To avoid the risk of accidentally resetting the thermal protection, this appliance must not be powered through an external switching device, such as a timer, or connected to a circuit that is switched on and off by the utility.
- **WARNING: do not use the fan heater with a controller or any other device that activates the appliance automatically, as there may be a risk of fire if the fan heater is covered or incorrectly positioned.**
- Do not restrict the air inlet and outlet grilles.
- The appliance heats up significantly when running and can cause burns. Avoid unprotected contact with the hot surface.
- Keep flammable materials, such as furniture, cushions, blankets, paper,

cloths, curtains and similar items at least 1 m away from the front, sides and back of the appliance.

- Disconnect the mains power when the appliance is not in use or during cleaning.
- Avoid using the fan heater in dusty environments or in the presence of flammable vapours (e.g. in workshops or garages).
- Do not place anything on the product; avoid placing wet garments on the fan heater.
- Use the heater in a well-ventilated area.
- Avoid placing fingers or foreign objects in the air inlet/outlet grilles, as this may lead to electric shock or fire and may damage the appliance.
- To avoid the risk of fire, do not block the grilles or tamper with them in any way while the fan heater is in use.
- **Do not use the appliance if the power cable or plug are damaged.**
If the power cable is damaged, it must be replaced by the manufacturer or its technical assistance service or in any case by a person with a similar qualification, in order to prevent any risk.
- Do not use the fan heater if it has fallen from a certain height or if it has been damaged in any way. Contact a service centre to check the fan heater or make any necessary electrical or mechanical repairs.
- The most common cause of overheating is the build-up of dust in the appliance. Remove accumulated dust by removing the plug and cleaning the grilles using a vacuum cleaner.
- Do not use any abrasive products to clean the appliance. Clean it using a damp cloth (not wet) rinsed with soapy water. Remove the plug from the socket before performing any maintenance.
- To disconnect the fan heater, turn the switch to OFF and remove the plug from the socket. Pull on the plug only. Do not pull on the cable when turning off the fan heater.
- Do not place any objects on the cable and also avoid bending the
- cable.
- Using extension leads is not recommended as they may overheat and cause a fire hazard. Never use a single extension lead to operate multiple appliances.
- Do not immerse the power cable, plug or any other part of the appliance in water or other liquids.
- Do not touch the plug with wet hands.

- Do not place the fan heater above or near another heat source.
WARNING: AVOID COVERING THE FAN HEATER TO PREVENT IT FROM OVERHEATING.

The symbol below signals this warning:



- The fan heater may cause the risk of fire if, while operating, it is covered or comes into contact with **flammable** material including curtains, drapery, blankets, etc. **KEEP THE FAN HEATER AWAY FROM THESE MATERIALS.**
- Do not connect the fan heater to the power supply until it has been correctly assembled or positioned.
- Do not run the cable under carpets. Do not cover the cable with blankets, carpets or similar materials. Place the cable away from busy areas and where it cannot accidentally be pulled out.
- Do not operate the fan heater in close proximity to bathtubs, showers, washbasins or pools.
- Do not use the appliance in the bathroom.
- The heating appliance must not be positioned immediately below a power outlet.
- Do not operate the appliance outdoors.
- Upon initial start-up, the fan heater may emit a slight, harmless smell. This smell is a normal effect of the initial heating up of the internal heating elements, and should not recur subsequently.
WARNING: THE ON/OFF SWITCH IS NOT THE ONLY METHOD OF DISCONNECTING THE MAINS POWER. ALWAYS UNPLUG THE APPLIANCE DURING MAINTENANCE OPERATIONS, WHEN MOVING IT OR WHILE IT IS NOT IN USE.
- A fan heater contains parts that generate electrical arcs and sparks. It must not be used in potentially dangerous areas such as those subject to the risk of fire or explosion, or areas filled with chemical substances or humidity.
- Do not use the appliance on soft surfaces such as beds, where the grilles may get covered. Always rest the fan heater on a flat and stable surface when it is running, so as to prevent it from toppling. Arrange the cable so that neither the fan heater or other objects can be on top of it.
- Always unplug the appliance when it is not in use.
- Turn the appliance off if unattended, in order to prevent accidents.

- In the event of any anomalies (abnormal noise or a strange smell), immediately turn off the appliance; do not attempt to repair it but take it to your local service centre.
- Do not inhale the steam emitted from the nozzle.
- Do not use acidic or basic solvents to clean the inside of this appliance: the residues could affect the proper functioning of the appliance.
- Do not use the appliance on unstable surfaces, otherwise the flow of water coming out could wet the floor or cause malfunction.
- Do not place the appliance on a high or sloping surface, otherwise it could fall during a vibration or an accidental push. Placing the appliance on a sloping surface could cause a malfunction of the device that controls the water level in the humidifier, resulting in a stoppage of operation or water leakage.
- Do not place the appliance in places with a strong magnetic field: this could cause malfunctions.
- Do not place the appliance on or near furniture or curtains. The steam could wet the furniture or curtains causing discoloration or shape. Furthermore, the white powder contained in the steam could alter the surface of the furniture: it is therefore advisable not to direct the steam jet directly towards the furniture.

WARNING

- **To move the appliance, lift the base without tilting the unit, to avoid water spills.**
- To fill or empty the tank, hold the upper part of the unit on both sides.
- During operation, do not open the appliance, do not come into contact with the water that forms in the lower part, do not scratch the atomizer or the ceramic disc with hard objects.
- The internal ultrasonic nebulizer is highly sensitive. Do not touch it with your fingers or rub it with metal accessories to avoid reductions in the emission of steam.
- **CAUTION: An excessively humid environment sively humid can encourage the proliferation of microorganisms: therefore, avoid curtains or carpets from absorbing excessive humidity.**
- It is also a good idea to remove any water remaining in the tank after

each use and refill the water tank with clean water every day.

- Clean the water tank and the nebulizer every 3 days and keep them clean. Do not add aromatic fragrances to the water in the tank.
- Do not connect the appliance to the power supply if there is no water in the tank or the appliance is upside down: this will cause the nebulizer to malfunction.
- Do not move the appliance during operation: this could cause water leaks or malfunctions.
- During operation, do not touch the water or the internal parts of the appliance with any part of the body.
- During the winter season, the water in the tank could freeze, causing malfunctions. Remove the water from the tank.
- Maintain the appliance by thoroughly cleaning the tank and the nebulizer regularly.
- Do not leave water in the tank and water duct if the product is not in use.
- Do not insert water or objects into the air inlet and outlet, do not block the air inlet and outlet. Do not insert water directly into the water duct.
- Do not use hot water to avoid damage to the parts that generate steam.
- Do not permit the area around the humidifier to become damp or wet. If dampness occurs, turn the output of the humidifier down. If the humidifier output volume cannot be turned down, use the humidifier intermittently. Do not allow absorbent materials, such as carpeting, curtains, drapes, or tablecloths, to become damp
- Empty and clean the humidifier before storage. Clean the humidifier before next use.
- Warning: Micro-organisms that may be present in the water or in the environment where the appliance is used or stored, can grow in the water reservoir and be blown in the air causing very serious health risks when the water is not renewed and the tank is not cleaned properly every 3 days.
- Empty the tank and refill every 3 days. 
- Before refilling, clean it with fresh tap water or cleaning agents if required by the manufacturer. Remove any scale, deposits, or film that has formed on the sides of the tank or on interior surfaces, and wipe all surfaces dry.

The manufacturer cannot be held responsible if the indicated safety and accident prevention regulations are not respected.

DESCRIPTION OF PARTS

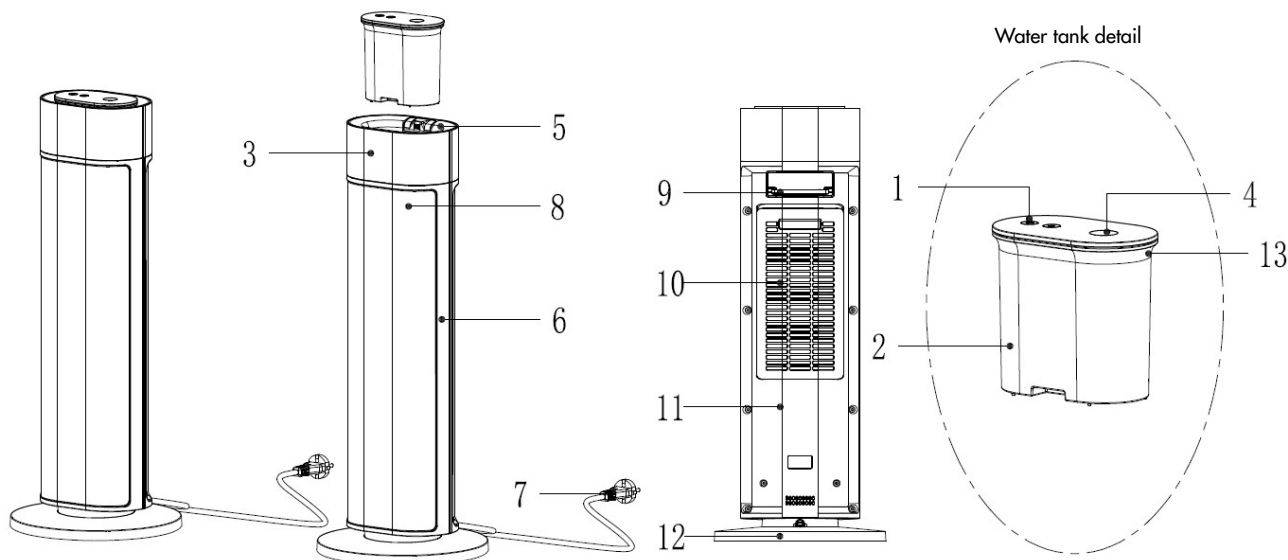

- | | |
|--|-------------------------------|
| 1. On/Off button with green LED contour | 7. Power cord |
| 2. Water tank, to be inserted in the top, for humidification | 8. Air outlet |
| 3. Control panel | 9. Remote control compartment |
| 4. Steam outlet | 10. Air filter |
| 5. Water tank cover | 11. Rear panel |
| 6. Front panel | 12. Base |
| | 13. Air outlet |

HOW TO ASSEMBLY THE FAN HEATER

PRODUCT ASSEMBLY PROCEDURE

Before operating the appliance, it is necessary to proceed with assembly. Place the base on a flat and stable surface, align the body of the product with the base and assemble as indicated below: align the power cord hole with the u-shaped groove on the base and press until you hear the sound of the product being hooked.

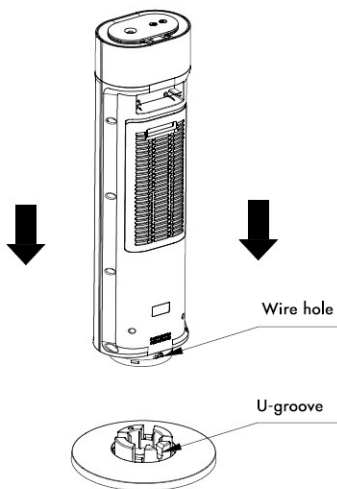

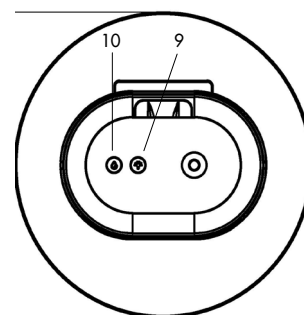
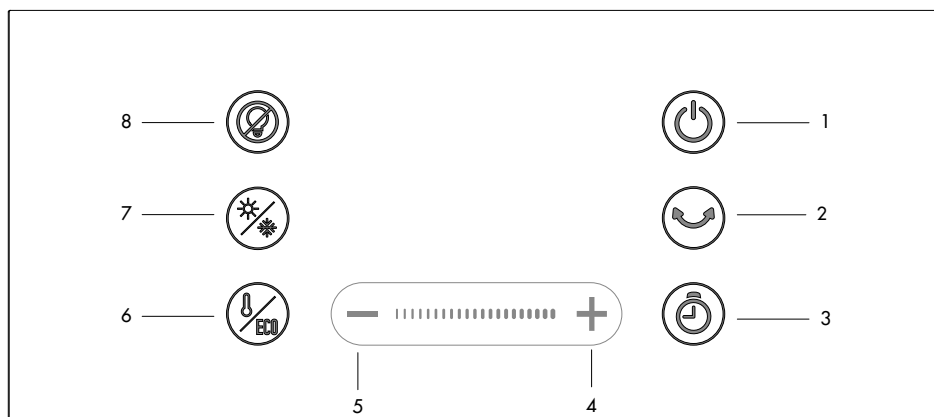

CONTROL PANEL AND OPERATION BUTTONS



Place the fan heater on a flat and stable surface. Connect the power cord to an appropriate power outlet (220-240V~/50-60 Hz).

1. POWER BUTTON

Touch this button on the control panel or press it on the remote control, a beep sounds and the appliance turns on. The default settings are: COMFORT heating mode (the LED  lights up), the display shows the temperature of 35 and the LED  lights up. The fan starts up.

To turn off the appliance, press this button again, the operation stops while the fan continues to operate for 30 seconds.

2. SWING BUTTON

Touch this button on the control panel or press it on the remote control to activate the horizontal oscillation of the fan heater, the LED  lights up on the control panel. To deactivate the oscillation function, touch this button again.

3. TIMER BUTTON

With the unit turned on, touch the Timer button on the control panel or press it on the remote control to select the switch-off interval in the following circular sequence 0h (disable Timer), 1h, 2h, 3h ... up to 24 hours. If during the time setting no selection is made within 5 seconds or if the setting is not performed with the Power button and the + - buttons, the setting is confirmed and the countdown to switch off the appliance begins. When the countdown ends, the appliance switches off and enters stand-by mode without emitting any sound signal.

In stand-by mode, press the Timer button, the h LED lights up and it is then possible to select the switch-on interval in the following circular sequence 0h (disable Timer), 1h, 2h, 3h ... up to 24 hours. If no selection is made within 5 seconds while setting the time or if the setting is not performed with the Power button and the + - buttons, the setting is confirmed and the countdown to switch on the appliance begins. When the countdown ends, the appliance starts to operate according to the last settings selected before switching off (the switch-off timer is not memorized).

4.5. + - BUTTONS

Touch the + - buttons on the control panel or press them on the remote control to set the temperature and set the Timer. Holding the buttons down for 2 seconds will speed up the setting.

6. TEMPERATURE ADJUSTMENT BUTTON AND ECO SMART MODE SELECTION

Touch this button on the control panel or press it on the remote control to set the temperature and activate the Eco Smart function in the following circular sequence: temperature setting - Eco Smart

The temperature setting range is from 15°C to 35°C. If no selections are made during the temperature setting or if no other buttons are touched except the Power button and the + - buttons, the setting is confirmed.

When the room temperature reaches the set temperature, all functions are deactivated and the appliance enters stand-by mode.

When the room temperature drops below 2°C compared to the set temperature, the appliance switches on and starts to operate.

The display shows the room temperature by default only when the Timer is activated. The display shows, alternately, the temperature and the countdown, at intervals of 30 seconds.

Eco Smart Mode: When this mode is activated, the LED  lights up on the control panel. The appliance works automatically based on the temperature detected in the room to allow energy saving and more efficient use of the

appliance:

When the room temperature is equal to or lower than 18°C, the appliance works in Eco mode

When the room temperature is higher than 18°C but lower than 25°C, the appliance works in Eco mode

When the room temperature is equal to or higher than 25°C, all functions are deactivated and the appliance goes into stand-by: in this mode, it is not possible to set the temperature, but the default temperature, 25 °C, applies.

7. HEATING MODE SETTING BUTTON

Touch this button on the control panel or press it on the remote control to set the desired heating mode in the following circular sequence: Eco - Comfort - Antifreeze

Eco mode: the appliance operates at a low heating level, the LED  lights up on the control panel

Comfort mode: the appliance operates at a high heating level, the LED  lights up on the control panel

When switching from Eco to Comfort mode, it will happen 10 seconds after the selection and the Eco LED will turn off.

Antifreeze mode: when the appliance enters intelligent antifreeze mode, the LED  lights up on the control panel and it works automatically to maintain the room temperature at 7°C.

8. DISPLAY LIGHTING DEACTIVATION BUTTON

Touch this button on the control panel or press it on the remote control to turn the control panel lighting on or off, all LEDs will turn off. To reactivate the lighting, touch this button again.

9. AMBIENT LIGHT BUTTON

Press this button on the top of the water tank to turn the ambient light on or off.

10. HUMIDIFICATION BUTTON

When the appliance is in operation, the countdown is automatically activated with an interval of 3 days. To indicate that it is necessary to proceed with cleaning, the LED on the edge flashes.

In the presence of a cleaning warning, it is still possible to activate the humidification function: this cancels the countdown. It is also possible to activate or deactivate the heating function normally.

When humidification is activated, the appliance detects the level of water in the tank: if a lack of water is detected in the tank, after about 6 seconds the unit enters protection mode due to lack of water and the mood light flashes for 1 minute: then press the humidification button and the ambient light stops flashing.

The cotton stick is completely dry when switched on for the first time, it is advisable to immerse it completely in water to speed up absorption times.

AUTOMATIC STAND BY FUNCTION

After 12 hours of consecutive operation and if no selections are made, the appliance automatically switches off and enters stand by mode.

NIGHT FUNCTION

After 1 minute of operation, if no selections are made, the LEDs on the display are deactivated so as not to disturb during your night's rest. To reactivate the lighting, touch any button on the control panel.

MEMORY FUNCTION

The appliance memorizes the last settings selected when it is switched on again (except the timer); this condition does not occur in the event of an accidental interruption of the power supply during operation.

ANTI-OVERHEATING DEVICE

The appliance is equipped with a safety device that switches it off in the event of overheating. If the safety device has intervened, switch off the fan heater, unplug the appliance and let it cool completely, check that there are no obstructions to the air inlet or outlet and try to restart it. If it does not work or the safety device switches it off again, take the heater to a nearest service center for inspection or repair.

ANTI-TIP-OVER SAFETY DEVICE

This appliance is equipped with a safety device that switches off the heater in the event of accidental tipping. To reset it, unplug the appliance from the power outlet for a few minutes, eliminate the cause of the tipping and reconnect the appliance. If the problem persists, contact a service center for inspection and repair.

REMOTE CONTROLLER

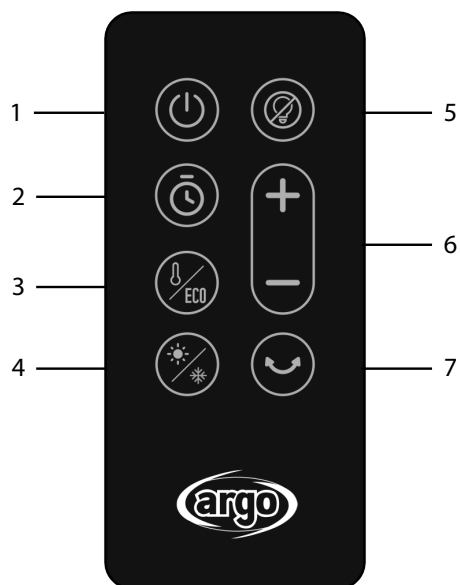

1. Power button
2. Timer button
3. Temperature adjustment button and Eco Smart function setting
4. Heating mode setting button
5. Control panel lighting off button
6. + - buttons
7. Swing button

The functions of the remote control correspond to those on the control panel. When using for the first time, remove the transparent film applied to the remote control.

Use a Lithium/Manganese button cell, model no. CR2025-3 V, compliant to REGULATION (EU) 2023/1542.

The battery is supplied with the product, on first use remove the plastic tab inserted in the remote control to allow its operation.

HOW TO INSERT/REMOVE THE REMOTE CONTROL BATTERY (refer to the drawings below)

Open the battery door on the back of the remote control, press the back and pull the right door. Insert the battery in the cover, taking care to check the correct positioning of the polarity. Insert the cover into the remote control.

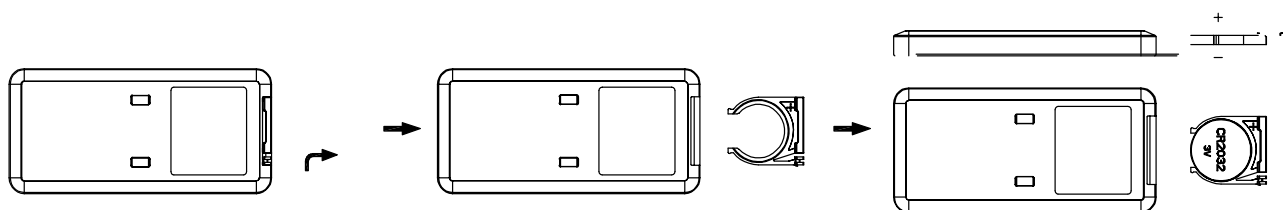

WARNINGS FOR BATTERIES

Batteries must not be exposed to heat sources such as fire, sun or similar sources;

Remove the batteries if they start to heat up or you know you will not use the appliance for a long time.

- The batteries must be installed correctly in the appropriate battery compartment;
- When you remove the batteries because they are damaged or at the end of their life, dispose of them according to the national regulations in force and indicated below.
- In case of battery fluid leak, remove all batteries, avoiding the leaked liquid from coming into contact with skin or clothes. If liquid from the battery comes into contact with skin or clothing, wash the skin with water immediately. Before inserting new batteries, carefully clean the battery compartment with a paper towel, or follow the battery manufacturer's recommendations for cleaning.
- Warning Danger of explosion if battery is replaced with an incorrect type. Use and replace only batteries with the same size and type.

Improper use of batteries can cause liquid leakage, overheating or explosion. This liquid is corrosive and can be toxic. It can cause skin and eye burns, and is harmful to ingest.

To reduce the risk of injury:

- Keep batteries out of the reach of children

- Do not heat, open, puncture, cut or throw batteries into fire
- Do not mix old and new batteries or batteries of different types
- Do not leave metal objects that can come into contact with the battery terminals and therefore can heat up and/or cause burns.



INFORMATION FOR THE CORRECT DISPOSAL OF BATTERIES IN ACCORDANCE WITH REGULATION (EU) 2023/1542.

Replace batteries when they are depleted. At the end of their life, batteries must be disposed of separately from unsorted waste. They must be taken to designated recycling centres or returned to a retailer providing this service. Separate disposal of batteries prevents potential negative effects on the environment and human health due to inadequate disposal, and also allows their constituent materials to be recovered and recycled, resulting in significant savings in terms of energy and resources. In order to highlight the obligation regarding separate disposal, the battery carries the crossed-out dustbin symbol. Illegal disposal of the product by the user may lead to administrative sanctions being applied as per current regulations.

MAINTENANCE AND STORAGE

CAUTION: ALWAYS UNPLUG THE APPLIANCE BEFORE CLEANING OR MAINTENANCE OPERATIONS.

IMPORTANT: DO NOT IMMERSE THE CERAMIC FAN HEATER IN WATER

Cleaning the outside surface of the appliance

Use a soft cloth to remove any dust from the fan heater. If the fan heater is excessively dirty, use a soft cloth dampened with water and neutral detergent at a temperature below 50°C. Leave the fan heater to dry completely before using it again. Do not use corrosive detergents or solvents such as petrol. Do not wash the appliance with water. When cleaning the appliance, do not use oils, chemical substances or other items that may damage the surface. Use a vacuum cleaner to remove dust from the air inlet/outlet grilles.

STORAGE

If the appliance is not used for prolonged periods, it must be stored together with this manual in its original packaging, in a cool and dry place.

INFORMATION REQUIREMENTS FOR ELECTRIC LOCAL SPACE HEATERS

Table 3 - Annex II - Ecodesign requirements - Requirements for product information – COMMISSION REGULATION (EU) 2024/1103 of 18 April 2024 implementing Directive 2009/125/EC of the European Parliament and of the Council as regards ecodesign requirements for local space heaters and separate related controls and repealing Commission Regulation (EU) 2015/1188.

Contact: ARGOClima SPA - Via A. Varo,35 - Alfianello (BS) - ITALY - www.argoclima.com						
Model Identify: ARGO TECH TOWER HUMY						
Item	Symbol	Value	Unit		Item	Unit
Heating capacity					Type of heat output / room temperature control (select one)	
Nominal heat output	P_{nom}	2,000	kW		Single stage heat output and no room temperature control	[no]
Minimum heat output (indicative)	P_{min}	1,300	kW		Two or more manual stages, no room temperature control	[no]
Maximum continuous heat output	$P_{max,c}$	2,000	kW		Mechanic thermostat room temperature control	[no]
Power consumption					Electronic room temperature control	[yes]
In off mode	P_o	N.D.	W		Electronic room temperature control plus day timer	[no]
In standby mode	P_{sm}	0,48	W		Electronic room temperature control plus week timer	[no]
In idle mode	P_{idle}	0,47	W		Other control options (multiple selections possible)	
In network standby	P_{nsm}	N.D.	W		Room temperature control, with presence detection	[no]
Standby mode with display of information or status			[no]		Room temperature control, with open window detection	[no]
Seasonal space heating energy efficiency in active mode	$\eta_{s,on}$	91,5	%		Distance control option	[no]
					Adaptive start control	[no]
					Working time limitation	[yes]
					Black bulb sensor	[no]
					Self-learning functionality	[no]
					Control accuracy	[no]



INFORMATION FOR CORRECT DISPOSAL OF THE PRODUCT IN ACCORDANCE WITH THE EUROPEAN DIRECTIVE 2012/19/EU

At the end of its working life this equipment must not be disposed of as an household waste. It must be taken to special local community waste collection centres or to a dealer providing this service. Disposing of electrical and electronic equipment separately avoids possible negative effects on the environment and human health deriving from an inappropriate disposal and enables its components to be recovered and recycled to obtain significant savings in energy and resources. In order to underline the duty to dispose of this equipment separately, the product is marked with a crossed-out dustbin



improve your life

www.argoclima.com

Argoclima assumes no responsibility for any errors or inaccuracies in the content of this manual and reserves the right to make any changes to this manual at any time and without notice, deemed appropriate for any technical or commercial need.